



A PRACTICAL GUIDE TO WASTE MANAGEMENT

please keep

*Managing our waste,
together!*



mrc
La Haute-Yamaska
Prospère de nature

GRANBY | ROXTON POND | SAINT-ALPHONSE-DE-GRANBY
SAINT-JOACHIM-DE-SHEFFORD | SAINTE-CÉCILE-DE-MILTON
SHEFFORD | WARDEN | WATERLOO

A Word from Your Warden

The MRC has been offering waste collection services since 2009. Whether the collections are for recyclables, leaves or Christmas trees, the participation of the citizens of Haute-Yamaska has been noteworthy.



To support community recycling efforts, your MRC broadened its range of services with the construction of two modern ecocenters. Located in Granby and Waterloo, these infrastructures are now at your disposal. If you haven't already, I invite you to pay your first visit to these facilities and bring with you any materials that might be reclaimed or recycled.

Our ecocenters also accept Household Hazardous Waste (HHW). This type of waste very often comes from products that are used routinely around the house – we all have some. It is important not to dispose of them in the trash as they present a very real danger to the environment and public health: they can easily contaminate the soil as well as underground water sources.

I invite you to read our Practical Guide to Waste Management, which contains more ample information about hazardous household wastes and other services that are available to you. Be sure to keep it handy for future reference.

One single phone number connects you to a dedicated staff that can answer any question about our various services. Don't hesitate to call us so that, together, we can continue our efforts to reclaim our resources.

A stylized, handwritten signature in black ink, appearing to read 'Pascal Russell'.

Pascal Russell
Warden, MRC de la Haute-Yamaska



Contents

Ecocentres	4
Materials Accepted and Refused	6
Addresses and Business Hours	7
HHW – Hazardous Household Waste	8
Quick Reference mini-poster	10
Recyclables	12
Leaves and Christmas Trees	14
Garbage and Bulky Waste	15
Wheeled Bins	16
Waste Reducing Tips	18
Grass Cycling and Composting	19

MRC de La Haute-Yamaska

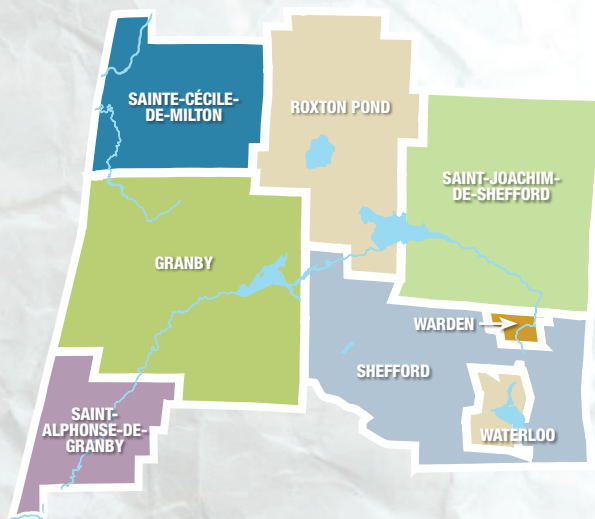

Info-collectes line

450 378-9976, ext. 2231

www.haute-yamaska.ca

What is an Ecocenter?

Ecocenters are secure sites where all citizens can dispose of various waste materials free of charge, for reclamation or recycling instead of landfilling. Ecocenters also allow sound management of the hazardous household wastes found in the average home, to keep them from contaminating the environment.

How do ecocenters work?

The citizens each take their own waste materials to the ecocenter of their choice. They pre-sort them and deposit them in the appropriate containers, or as directed by the attendant.



“ If properly pre-sorted in your vehicle, your waste materials will be easy to drop into the right containers at the ecocenter! ”

Proper sorting makes reclaiming easy!

Why is it crucial to sort your materials before you get to the ecocenter?

1. Sorting at home will make your task easier once you get to the ecocenter.
2. Only sorted materials can be sent to specialized recyclers. Proper sorting means improved reclaiming.
3. In this way, the MRC and its citizens can significantly reduce the volume of waste that goes to the landfill.

What you need to **know**

- It is preferable to sort your materials into categories as you load your vehicle or trailer so that you can deposit each type of material in the appropriate place once you reach the ecocenter.
- It is not the attendants' job to help citizens unload. If you think you are going to need help, plan to bring someone with you.
- Plan to wear safe shoes and clothing, and bring whatever equipment you will need to manually unload your waste materials (shovel, gloves, etc.).
- The barriers in front of the containers are there to prevent falls and will not be opened under any circumstances.

“ The ecocenter is not a dump, it is a reclamation site. It does not accept garbage.”





MATERIALS

Accepted

Household Hazardous Waste (HHW)

Paints, solvents, batteries, paint strippers, compact fluorescent bulbs, pesticides, etc.

See pages 8 and 9 for more about HHW

Tree branches and trunks

Tree branches and trunks less than 1.5 m in length and 22" in diameter; natural Christmas trees without decorations

Yard waste

Leaves, sod, dried plants and weeds, mulch, etc.

Construction/Renovation/Demolition Waste

Wood (with or without nails, untreated with creosote), gyproc no more than 2.45 m (8') in length, windows, doors, sinks, toilets, window glass, mirrors, ceramic ware, shingles, etc.

Metal

Iron, aluminum, empty paint containers, electrical wire, clothes lines, clothes hangers, baling wire, etc.

Granular materials

Stones, uncontaminated soil, rock, concrete (non-reinforced), brick, asphalt, etc.

Home Electronics and Appliances

Computers, printers and cartridges, televisions and VCRs, cell phones, cameras, small power tools and appliances, etc.

Tires

Automobile and bicycle tires without rims (48.5 inches or less)

Appliances Containing Halocarbon

Refrigerators, freezers, air conditioners, etc.

Polystyrene (Foam)*

Uncontaminated polystyrene used in insulation or packaging.

** Material accepted as part of a pilot project, subject to change without notice.*

Bulky Waste

Furniture, shower stalls, bathtubs, mattresses, swimming pools, patio umbrellas, toilets, infant seats, carpeting or linoleum rolled and tied, etc.

Fabric and Clothing

Please note that this list of accepted materials can change at any time.



MATERIALS

Refused

- Asbestos
- Reinforced concrete
- Creosote-treated wood
- PCB waste
- Compressed gas cylinders over 1 litre (excluding propane)
- Animal carcasses
- Cyanide
- Radioactive or biomedical waste
- Household waste
- Items damaged in a fire
- Firearms, ammunition
- Tires larger than 48.5 inches
- Products containing asbestos
- Explosives
- Contaminated soil
- Hazardous waste from commercial or industrial sources



To dispose of other materials not listed in this guide, please refer to the Bottin Vert [green directory] on our website at www.haute-yamaska.ca

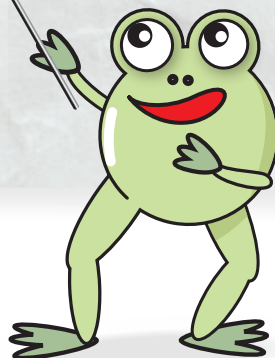

HHW: Hazardous and Common!

Household Hazardous Waste (HHW) are products in common use around the house. They are hazardous to the health and to the environment. Thrown in the trash or poured down the drain, they contaminate the soil as well as surface and ground water sources.

Take your HHW to one of our two ecocenters, in their original container or in a clearly-marked closed container. They will be safely recovered, and then recycled or reclaimed.

HHW can be recognized by the pictograms on their labels:





EXAMPLES OF HHW accepted

In the kitchen:

- Oven cleaners
- Metal cleaners
- Fondue fuel
- Liquid drain cleaners
- Scouring powders
- Floor and furniture waxes
- Cleaners containing ammonia
- Smoke detectors and thermometers (they contain mercury)

In the basement and closets:

- Paints, stains, varnishes, wood preservatives and solvents
- Batteries
- Compact fluorescent bulbs and fluorescent tubes
- Solvent-based glues
- Wood strippers
- Rat poison

In the garage or garden shed:

- Chemical fertilizers
- Pesticides
- Pool and spa chemicals
- Car batteries
- Used oil, fuel oil, containers and filters
- Gasoline
- Propane tanks
- Pressurized containers and aerosols
- Antifreeze
- Antigel

In the bathroom:

- Hair dye and hairspray
- Rubbing alcohol and peroxide
- Disinfectants
- Bath and bowl cleaners
- Nail polish and polish remover
- Other beauty products

In the laundry room:

- Detergents and stain removers
- Fabric softeners
- Bleach



Do you know why they are hazardous?

Certain products in common use are HHW, but we don't always know why they are hazardous:

Batteries

contain heavy metals, such as lead, nickel and zinc, that are reactive and corrosive.

Compact fluorescent bulbs

contain mercury.

Small electronic devices

(MP3 players, cell phones, tablets, etc.) also contain heavy metals, as well as chemical compounds called flame retardants.

Special care must therefore be taken with these small objects of daily life.

They are convenient and useful...
but far from harmless!

Never dispose of them in the trash.
Instead, take them to an ecocenter.

MAKE AN INFORMED CHOICE

to Recycle, Reuse & *instead of* throwing away!

Services within your reach!

1 Recyclables Collection

PAPER AND CARDBOARD

Newspapers and magazines, paper sheets and flyers, paper bags, cardboard boxes and rolls, gable-top milk and juice cartons, Tetra Pak type containers.

PLASTIC

Bottles, containers and clear packaging marked #1 through #5, as well as #7, caps and lids, bags and plastic wrappers.

GLASS

Bottles and jars, regardless of colour.

METAL

Aluminum containers and foil, aluminum bottles and cans, tin cans, caps and lids.

MORE INFORMATION ON
pages 12 and 13

2 Grasscycling and Composting

GRASSCYCLING

Leave grass clippings on the ground after mowing; this is known as grasscycling. It is an excellent way to feed your lawn!

COMPOSTING

If you have enough space, you can compost your garden waste and table scraps!

MORE INFORMATION ON
page 19

3 Special Collections

Leaves and garden waste (flowers, stalks, etc.)

Natural Christmas trees

MORE INFORMATION ON
page 14



To dispose of other material not listed in this guide, please refer to the Bottin Vert [green directory], on our website.

Reclaim



4 Bulky Waste Collection

Refrigerators, freezers, hot-water heaters, furniture, sofas, mattresses, carpets, etc.

5 Ecocenters & HHW (HOUSEHOLD HAZARDOUS WASTE)

Paints, solvents, batteries, aerosols, etc.

YARD WASTE

Wood, branches, leaves, etc.

CONSTRUCTION/RENOVATION

Lumber, windows, gyproc, toilets, window glass, ceramic ware, shingles, etc.

METAL

Iron, Aluminum, empty paint cans, electrical wire, etc.

GRANULAR MATERIALS

Stone, concrete, bricks, uncontaminated soil, asphalt, etc.

HOME ELECTRONICS AND APPLIANCES

Computers, televisions, cell phones, small power tools and appliances, etc.

HOUSEHOLD APPLIANCES

Refrigerators, freezers, air conditioners, etc.

6 Garbage Collection

Only waste that you were unable to dispose of otherwise ultimately.

This waste is headed for the landfill. In our efforts as a society to reduce and reclaim waste, it is important to optimize all available resources and throw out as little as possible.

MORE INFORMATION ON
page 15

MORE INFORMATION ON
pages 4 to 9



mrc
La Haute-Yamaska
Prospère de nature

For more information,
contact us at

450 378-9976, ext. 2231

or visit our website at

www.haute-yamaska.ca



HAUTE-YAMASKA
100% ÉCO

Materials accepted in the recycling bin

While recycling has long since become a daily habit, it is always good to refresh our memories regarding what is recyclable and what isn't.

Review the following list to improve your recycling.

PAPER AND CARDBOARD

- newspapers, flyers, magazines
- paper sheets, envelopes and paper bags
- books and phone directories
- cardboard rolls
- cardboard boxes
- egg cartons
- gable-top milk and juice cartons
- aseptic containers (Tetra Pak^{MD} type)

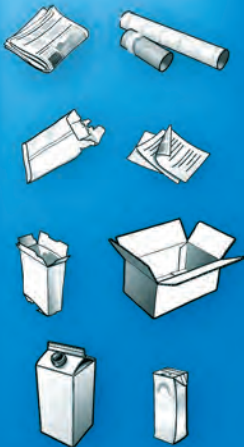

PLASTIC

- Bottles, containers and packaging from food, beverages, cosmetics, personal grooming and household cleaning products, identified by one of these symbols:



- Caps and lids
- Bags and wrappers



GLASS

- Bottles and jars, regardless of their colour



METAL

- Aluminum containers and foil
- Aluminum bottles and drink cans
- Tin cans
- Caps and lids



REMINDER



Do not

PLACE IN THE BLUE BIN

- Styrofoam
- Wood
- Crockery
- Building materials

- Batteries, paint, chlorine and other hazardous product containers
- Cardboard and paper soiled with grease

Tips for better recycling!



- Gather plastic bags together in a single bag. Do the same with shredded paper.
- Rinse out metal, rigid plastic and glass containers.
- Make more room in your bin by flattening boxes.
- Remove the flyers from the Publi-Sac bag.

What happens to materials that are not recycled?

When waste is not recovered and is sent to a landfill instead, it doesn't just disappear!

Some waste materials take years to degrade, for example:

Aluminum drink can.....	200 to 500 years
Tin can.....	10 to 100 years
Newsprint.....	3 to 12 months
Plastic bottle.....	100 to 1000 years

RECYCLABLES



Leaves and garden waste

A small quantity of fallen leaves can be left on the ground or shredded with your lawnmower to provide a good source of natural fertilizer. If your lawn is completely buried in leaves, you can use them to amend your compost or you can use the MRC's leaf collection service.

REMINDER:

- There are three leaf collections in the fall and one in the spring (check your calendar).
- Only leaves and garden waste (flowers, stalks, etc.) placed in **paper leaf bags** specially designed for this purpose will be picked up. These bags may be purchased in various stores around the region.
- **Plastic lawn bags**, biodegradable or not, are **prohibited** for these collections.
- Place leaf bags **at least one (1) meter** from your wheeled bins.



Christmas Trees

A special Christmas tree collection is scheduled for early January (consult your calendar). Your recycled Christmas trees will be turned into wood chips for landscaping use.

REMINDER:

- **Remove all decorations** from your tree or it will not be picked up.
- **Do not stand your tree upright** in a snow bank... The driver doing the collecting will not know it is for pickup! Rather, **lay it on its side** on the ground in a spot visible from both sides of the street.
- In the days preceding the collection, keep your tree under cover to prevent it from being **buried in snow** or **frozen in the ice**.



Garbage

Your grey bin should be your last resort!

Only objects that cannot go in your blue bin, or be disposed of during special collections or at the ecocenters or other recycling organizations, should find their way into your grey bin. Also note that some items are prohibited in your grey bin.



Prohibited
IN THE GREY BIN



The best way
TO DISPOSE OF IT

Soil, gravel and
stone

At ecocenters

Debris from building construction,
demolition, and renovation

At ecocenters
Materials must be sorted separately

Paint, oil, grease and other
hazardous products

At ecocenters
Residential products only

Bulky Waste

Bulky waste collections are for disposing of objects that are acceptable as garbage but are **too large to fit in your grey bin**. For instance, **furniture, sofas, carpets, mattresses, appliances, etc.**

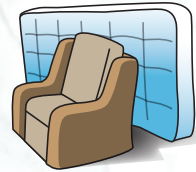

However, note that you cannot put just anything out for pickup!

Not bulky waste!



Prohibited
AS BULKY WASTE



The best way
TO DISPOSE OF IT

Debris from building construction,
demolition, and renovation, including
windows, cabinets, etc.

At ecocenters
Materials must be sorted separately

Bags and boxes of garbage, or
items destined for the garbage

Landfill

Branches piled pell-mell

Bulk waste collection
*Must be cut in lengths of no more
than 1.2 m and tied in bundles of
less than 22 kg*

Cars and bicycles tires

At ecocenters
Must be without rims

Instructions for Wheeled Bins

Pay special attention to the instructions below. They will help you manage your waste efficiently and ensure that it is picked up!

Where and how to position your bins?

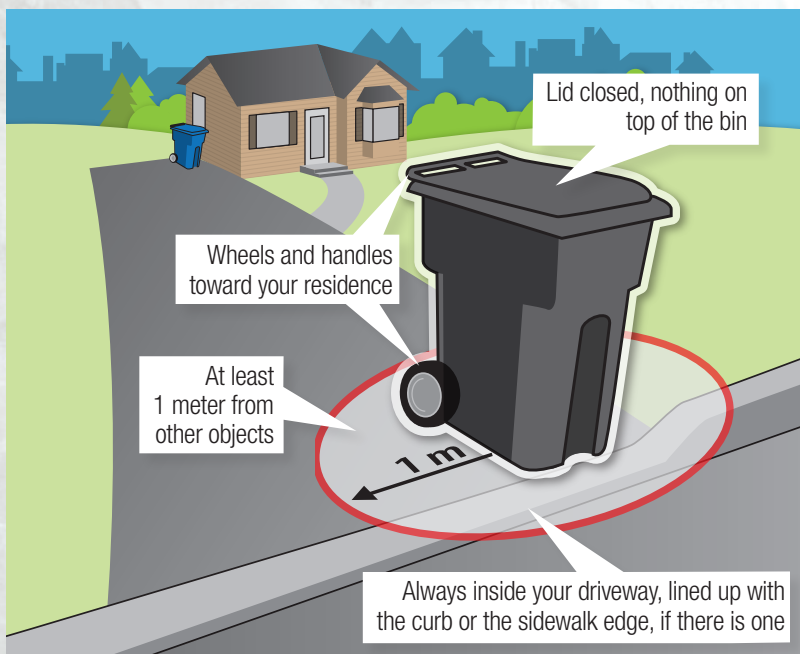

- To reduce the risks of breakage when the truck empties your bin, position the handles and wheels towards the house.
- To facilitate mechanical lifting, leave at least 1 m of space between each bin. Also, place each bin at least 1 m from any obstacle (pole, fence, mailbox).
- Do not place the bin in front of a legal parking space on the street; if a car is parked there when the truck goes by, your bin will not be emptied.
- Garbage left next to the grey bins will not be picked up. Bins that are overloaded or have lids that will not close will not be emptied.



Position your blue bin in the same way as the grey bin

When to put them out?

After 7 p.m. the night before and before 6 a.m. on the day of the collection.

Maximum weight

The bins cannot be lifted if they weigh more than 90 kg (200 pounds). Do not put soil, cement, stones or other materials of this type in your bins; in any case these are prohibited in the garbage bin.



Don't block the sidewalk!

Think about people who use a cane, crutches or a wheelchair to get around, not to mention those who are visually impaired. Placed on the sidewalk, your bin becomes an obstacle for them.

And in winter?

After a snowstorm, it may be difficult for the trucker to empty your bin. Pay attention to elements that are likely to hinder the mechanical lift, such as snowbanks or parked cars. In fact, if your bin isn't full, you might choose to hold off until the next collection.

Do not place your bin on the sidewalk, as this could hinder pedestrian traffic as well as snow removal and sanding operations.

Your blue bin is no longer sufficient?

Does your blue bin overflow even when you take the time to break down your boxes? Call us at 450-378-9976 ext. 2231 to get a second bin, or to replace your current 240 L bin with a 360 L bin.

In case of breakage

The MRC repairs or replaces blue bins, which are its property. The grey garbage bin is the responsibility of the individual citizen. Replacement wheels and lids may be purchased from certain retail stores.

Moving?

Leave the recycling bin behind when you move. The blue bin is linked to the address.

What about dumpsters and recycling containers?

- Do not place bulky items (mattresses, furniture, etc.) near your building's recycling containers or dumpsters, as this makes it impossible to lift them. Instead, bulky waste items must be placed at the curb the night before the monthly collection (consult your calendar).
- Keep container lids closed, to keep rain and snow out.
- Requests for new containers must be made through the building superintendent or landlord.



Source Reduction

Garbage overflowing? There is a simple, logical solution: reducing at the source. If we consume responsibly, there will be less garbage to process and dispose of. The easiest waste to manage... is the waste we don't produce!

Before we purchase a new product, we should ask ourselves these questions: Can we do without it? Can we borrow it? Is there a version that is less damaging to the environment?

- **Opt for products with little or no packaging.** Choose bulk products, family-sized packages, or concentrates. Packaging accounts for up to 50% of the garbage in our landfills.
- **Borrow equipment or devices** that you only need for a short period from a friend or a neighbor.
- **Rent, rather than buy equipment** that is used infrequently, for instance rug shampoos and floor sanders.
- **Check the toxicity level of the item** and, as much as possible, buy the one that will not generate any Household Hazardous Waste when it is used or disposed of.

“ By changing our habits and consuming responsibly, we will generate less waste! Let's apply the principle of source reduction and make a difference... because reducing waste is taking action! ”

Grasscycling

Eco-Mowing: Simple as 1-2-3!

Don't throw out your grass clippings, grasscycle them instead. Just leave them on the lawn when you mow. The clippings break down in under 48 hours and become invisible. To accelerate decomposition, you can outfit your mower with a mulching blade, sold at hardware stores. Grasscycling is one of the simplest and most efficient ways of protecting the environment. So, there is absolutely no reason to put your grass clippings in the trash anymore.



Composting

Composting is easy!

For information on starting your own compost pile at home or tips on how to make composting easier, visit www.haute-yamaska.ca



Odours?

If you follow the recipe, your compost pile will not smell. If there are odours, it's because the ratio of kitchen scraps to brown materials is too high, or there is no longer any air circulation. Increase the volume of brown materials or aerate the pile more, and the odours will disappear.

Tree branches

Rent a wood chipper to effortlessly transform branches and shrubs into wood chips. Use them to mulch your flower borders and garden beds, or add them to your composter.

“ In Haute-Yamaska,
the environment
is our **greatest asset**”



MRC de La Haute-Yamaska
142, rue Dufferin, bureau 100, Granby, QC J2G 4X1
Tél. : 450 378-9976, ext. 2231
www.haute-yamaska.ca



Version française disponible sur demande.

Printed on unbleached, 100% post-consumer recycled paper.